

Retail and Services

When you join the retail and service businesses in Loggerhead Plaza, you join a group of well established businesses within the community, including Antonio's Deli, Michael Wilson Jewelry, Palm Beach Fabrics, Floridian Community Bank, Classico's Italian Restaurant, Cabinet Encounters, Juno Beach Fitness, Teak Garden, Ocean East Salon, Comprehensive Health Associates, Fantasia Restaurant Italiano, House of Appliances, and Signature Properties of the Palm Beaches.

With retail and service spaces directly on U.S. Highway 1, Loggerhead Plaza provides great visibility for your business in a location that the community is very familiar with.

Consider that...

- 28,132 people live within 3 miles of Loggerhead Plaza
- The residents of Juno Beach and the surrounding communities of Palm Beach Gardens and Jupiter are highly educated, professional and affluent
- 28,000 cars travel in front of Loggerhead Plaza on U.S. Highway 1 daily
- Your company will gain exposure to the tens of thousands of people who visit the Loggerhead Marine Life Center each year as it is right across the street from Loggerhead Plaza

First Floor Plan

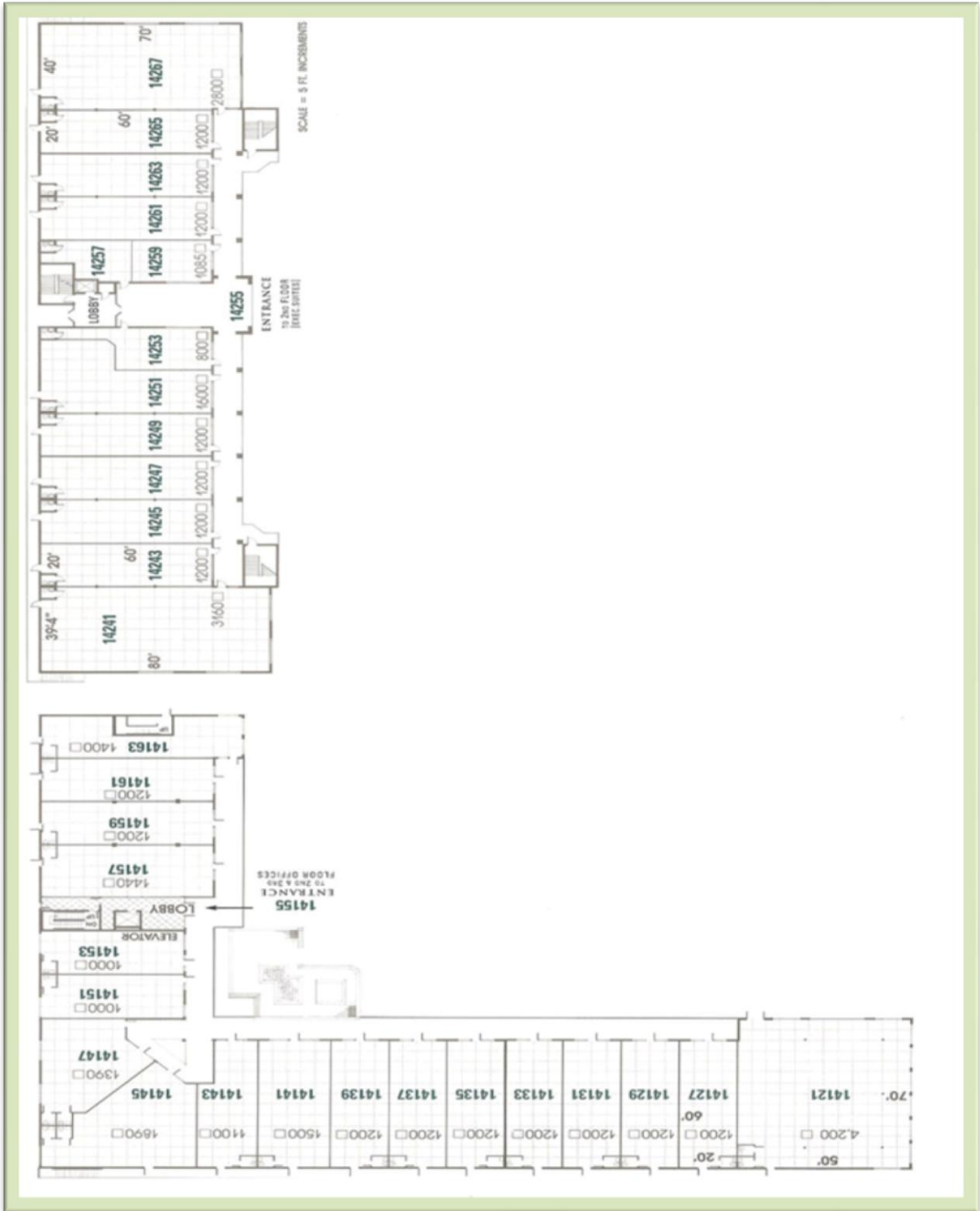

Parking Plan

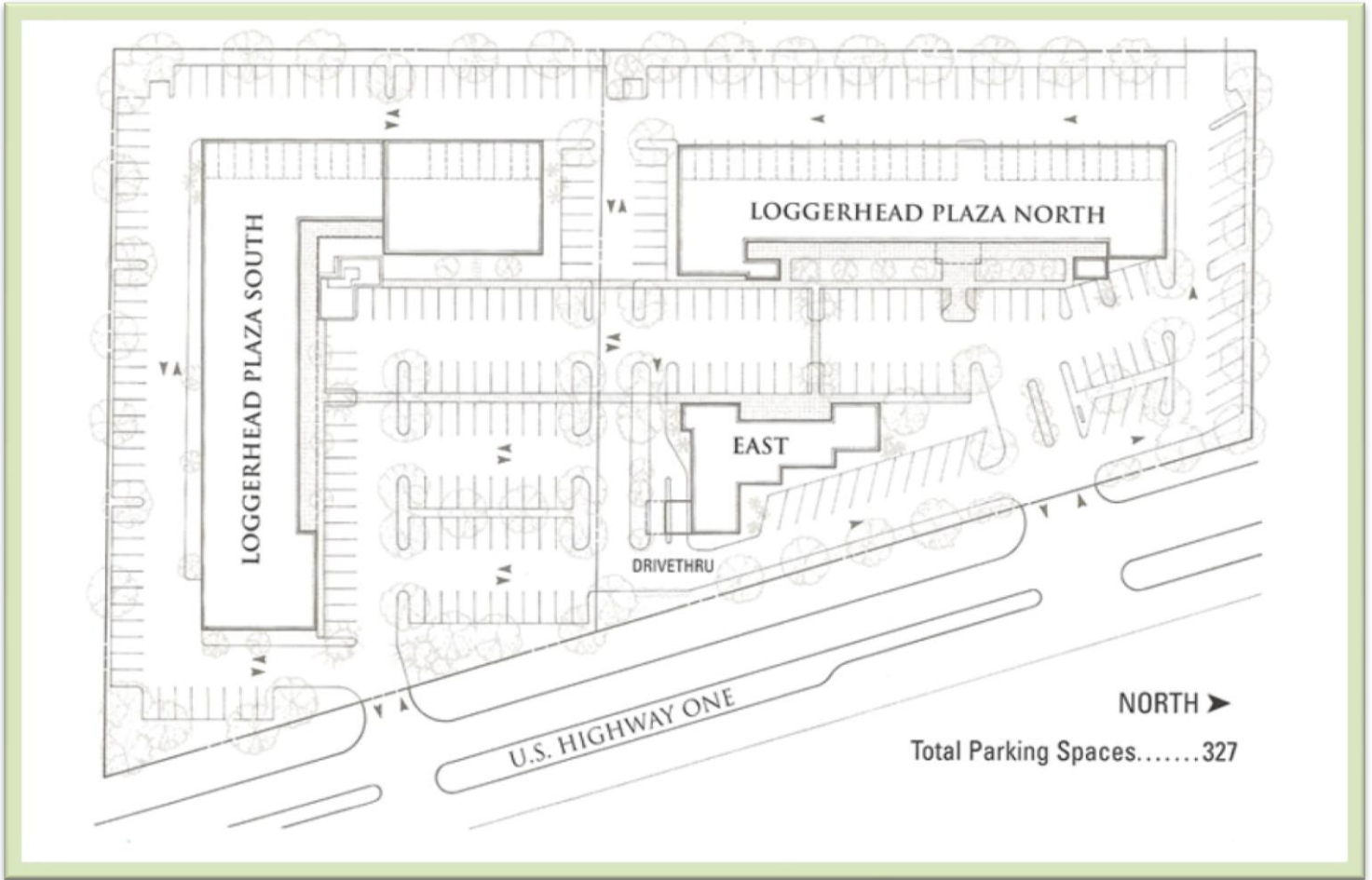

Loggerhead Plaza – 14255 U.S. Highway One – Juno Beach, FL 33408 – (561) 627-2702